

Gama style

A gama **STYLE** nasce da conjugação de inlays com jogos de folhas de madeira, criando designs exclusivos e contemporâneos que promovem a criatividade e a sofisticação do seu espaço.

The **STYLE** collection was born from the combination of inlays with veneers, creating unique and contemporary designs that promotes the creativity and sophistication of your space.

La gamme **STYLE** est née de la conjugaison des inlays avec des jeux de placages bois en créant des designs uniques et contemporains qui favorisent la créativité et la sophistication de votre espace.

Opções | Options



34 | 37 dB



EI 30 | 45 | 60



Contra radiações
Anti radiation
Anti rayons x



1H-4FA
Carvalho Cinza RW
RW Grey oak | Chêne Gris RW



1H1V-1FM | Carvalho RW
Oak RW
Chêne RW



1H2V-2FM | Carvalho RW
Oak RW
Chêne RW



1V-1FA | Faia Vaporizada
Streamed beech
Hêtre étuvé



1V-2FA | Faia Vaporizada
Streamed beech
Hêtre étuvé



1H2V-2FA | Carvalho RW
Oak RW
Chêne RW



1H-2FA | Carvalho RW
Oak RW
Chêne RW



1H-2FM | Carvalho RW
Oak RW
Chêne RW



1H1V-1FA | Carvalho RW (38)
Oak RW (38)
Chêne RW (38)



2V-1FA | Carvalho Nat. (38)
Natural oak (38)
Chêne naturel (38)



1H-4FM | Carvalho Nat.
Natural oak
Chêne naturel



1H-4FA | Carvalho Cinza RW
RW Grey oak
Chêne Gris RW



1H-6FA | Wengué RW
Wenge RW
Wenge RW

Nota: Os modelos apresentados estão disponíveis em várias cores e opções decorativas, consulte as páginas 18 e 19.

Note: The presented models are available in several options, please see pages 18 and 19.

Note: Les modèles présentés sont disponibles en différentes options, consultez les pages 18 à 19.



1H2V-2FA
Carvalho RW
RW Oak | Chêne RW



1H1V-1FCA | Carvalho RW
Oak RW
Chêne RW



2V-1FCA | Carvalho Nat. (38)
Natural oak (38)
Chêne naturel (38)



1H-1F+HA | Wengué RW (69)
Wenge RW (69)
Wenge RW (69)



4V2H-2FA | Wengué RW
Wenge RW
Wenge RW



1H1V-1FCA
Carvalho RW
Oak RW | Chêne RW

Pormenores de acabamento e textura
Finishing and texture details
Détails de la finition et de la texture

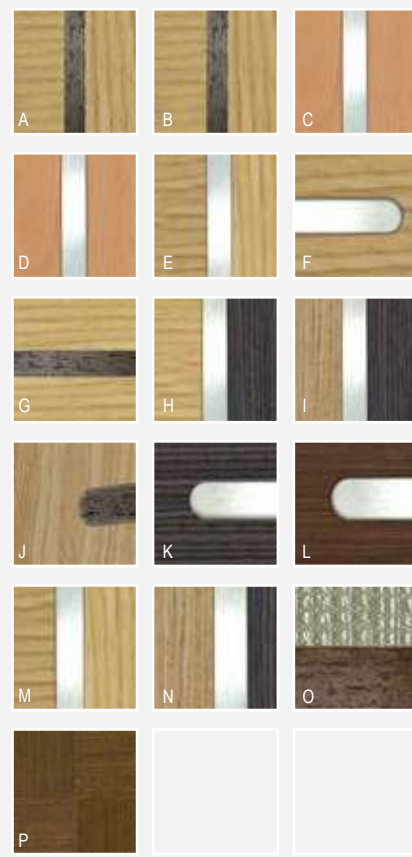

OPÇÕES DE COR | COLOR OPTIONS | OPTIONS DE COULEUR



VINYL

(1) Branco Artic Artic White Blanc Artic	(2) Branco Pérola White pearl Blanc perle	(3) Moldau Acácia Moldau Acacia Moldau Acacia	(4) Carvalho Antiqua Antiqua Oak Chêne Antiqua	(5) Olmo Escuro Dark elm Orme foncé	(6) Carvalho Plomo Plomo oak Chêne plomb	(7) Carvalho Brown Brown oak Chêne brun	(8) Light Grey	(9) Dark Grey
(10) Chestnut Bleached	(11) Chestnut Marron	(12) Olive	(13) Carvalho Savannah Savannah Oak Chêne Savannah	(14) Nogueira Cacao Cacao Walnut Noyer Cacao	(15) Concrete Concrete Beton	(16) Olmo Taupe Taupe Elm Orme Taupe	(17) Nogueira Cacao Cacao Walnut Noyer Cacao	(18) Nogueira Caramelo Caramel Walnut Noyer Caramel
(19) Vanilla Oak	(20) Pearl Oak	(21) Iron Oak	(22) Nature Oak	(23) Harvest Oak	(24) Honey Oak	(25) Arizona Oak	(26) Smoked Oak	(27) Graphite Oak
(28) Ivory Oak	(29) Castle Oak	(30) Arabian Oak	(31) Riga Amber	(32) Riga Terracota	(33) Dakota Oak	(34) Barley Oak	(35) Havana Oak	(36) Coyote Oak
(37) Bohemian Walnut	(38) Forest Oak	(39) Signature Oak						(40) Decor Branco White Decor Decor Blanc



BASIC | BASIC+ | STYLE | VINTAGE | CORES DA MADEIRA | WOOD COLORS | COULEURS DE BOIS

(41) Amapa	(42) Bambu Bamboo Bambou	(43) * Carvalho Natural Natural oak Chêne naturel	(44) Carvalho RW Oak RW Chêne RW	(45) Carvalho Cinza RW Gray oak RW Chêne gris RW	(46) Cerejeira USA Nat. USA natural cherry Cerisier EUA naturel	(47) Cerejeira USA RW USA Cherry RW Cerisier EUA RW	(48) Ébano Ebony Ébène	(49) Faia Vaporizada Streamed beech Hêtre étuvé
(50) Freixo Ash Frêne	(51) Maple Maple Érable	(52) Mogno Mahogany Acajou	(53) Mutene	(54) Nogueira Walnut Noyer	(55) Nogueira RW Walnut RW Noyer RW	(56) Pinho Pine Pin	(57) Sucupira	(58) Teka RW Teak RW Teck RW
(59) Tola	(60) Wengue RW	(61) Zebrano RW						



LACADOS | LACQUERED | LAQUÉS

GLAM | VINTAGE | GRAPHIC

(62) Branco White Blanc	(63) Cinza Grey Gris	(64) RAL 9006	(65) Preto Black Noir	(66) Vermelho Red Rouge	(67) Carvalho branco White oak Chêne blanc	(68) Branco craquelé White "craquelé" Blanc "craquelé"	(69) Preto craquelé Black "craquelé" Noir "craquelé"	RAL RAL RAL



HPL | COMPACT 3

(70) B070 Branco B070 White B070 Blanc	(71) Cinza G003 Grey G003 Gris G003	(72) Amarelo G031 Yellow G031 Jaune G031
(73) Vermelho R036 Red R036 Rouge R036	(74) Azul B086 Blue B086 Bleu B086	(75) Cinza G059 Grey G059 Gris G059



OPÇÕES DECORATIVAS | DECOR OPTIONS | OPTIONS DÉCORATIVES

TIPO DE FRISO | INSERT OPTIONS | OPTIONS DES FRISES

TODAS AS GAMAS | ALL RANGES | TOUS LES GAMMES

FM Madeira Wood Bois	FR Rebaixado Milled Fraisé	FA Alumínio Aluminium Aluminium

COR METÁLICA | METALLIC COLOR | COULEUR MÉTALLIQUE

BASIC | BASIC+ | STYLE | VINTAGE | GLAM | VINYL

(76) Luna Antracite Scudo

OPÇÕES DE VIDRO | GLASS OPTIONS | OPTIONS POUR LE VERRE

TIPO DE VIDRO | GLASS TYPES | TYPE DE VERRE

Transparente Clear Transparent	Fosco Frosted Dépoli	Espelho Mirror Miroir





TIPO DE BITE | GLAZING BEAD | PARCLOSE

STD Saliente Embossed En relief	FAC Face Flushed Affleurant

INTERIOR DA PORTA | DOOR INSIDE | INTÉRIEUR DE LA PORTE

ALVEOLAR (STANDARD) Honeycomb Carton nid d'abeille	AGLOMERADO Chipboard Aggloméré	EPS EPS EPS

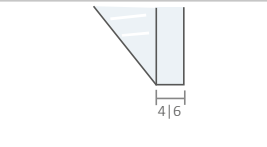
OPÇÕES DE ABERTURA | GLAZING OPTIONS | OPTIONS DE VITRAGE

<p>A1</p> <p>STD FAC CF 30 🔥</p>	<p>A2</p> <p>STD FAC CF 30 60 🔥</p>	<p>A3</p> <p>STD FAC</p>	<p>A4</p> <p>STD FAC</p>	<p>A5</p> <p>STD FAC</p>
<p>A6</p> <p>STD FAC</p>	<p>A7</p> <p>STD FAC</p>	<p>A8</p> <p>STD FAC CF 30 60 🔥</p>	<p>A9</p> <p>STD FAC CF 30 60 🔥</p>	<p>A10</p> <p>STD FAC CF 30 60 🔥</p>
<p>A11</p> <p>STD FAC CF 30 60 🔥</p>	<p>A12</p> <p>STD FAC CF 30 60 🔥</p>	<p>A13 - Royal</p> <p>FAC</p>	<p>A13 - Royal - Grade Grid Grille</p> <p>FAC</p>	<p>A14</p> <p>FAC</p>
<p>A15</p> <p>STD FAC CF 30 60 🔥</p>	<p>A16 - Divine</p> <p>FAC</p>	<p>TIPO DE BITE GLAZING BEAD PARCLOSE</p> <div data-bbox="730 1753 1161 2080"> <p>STD Standard Standard Standard</p>  <p>FAC Face Flushed Affleurant Disponível apenas no acabamento lacado ou folha de madeira natural Only available in lacquer or wood veneer Seulement disponible laqué ou en placage bois.</p>  </div>		<p>VIDRO GLASS VERRE</p> <div data-bbox="1209 1753 1481 1899">  <p>4/16</p> </div> <div data-bbox="1209 1921 1481 2080">  <p>CF Corta Fogo Coupe-Feu Fire Door</p> </div>

DIMENSÕES MÁXIMAS DE FABRICO

MAXIMALES DIMENSIONS FABRICATION | MAXIMUM MANUFACTURING DIMENSIONS

GAMA GAMA GAMA	COR COLOR COULEUR	LM ↔	HM ↕
VINYL	Branco Artic Artic White Blanc Artic	1250	3000
	Branco Pérola White pearl Blanc perle		
	Moldau Acácia Moldau Acacia	1400	
	Carvalho Antiqua Antiqua Oak Chêne Antiqua		
	Olmo Escuro Dark elm Orme foncé		
	Carvalho Plomo Plomo oak Chêne plomb		
	Carvalho Brown Brown oak Chêne brun		
	Light Grey Light Grey	1250	
	Dark Grey Dark Grey	1400	
	Chestnut Marrone Chestnut Marrone		
	Chestnut Bleached Chestnut Bleached		
	Olive Olive	1200	
	Carvalho Savannah Savannah Oak Chêne Savannah	1250	
	Nogueira Cacao Cacao Walnut Noyer Cacao		
	Concrete Concrete Beton	1400	
	Olmo Taupe Elm Taupe Orme Taupe	1250	

GAMA GAMA GAMA	COR COLOR COULEUR	LM ↔	HM ↕
VINYL	Vanilla Oak Vanilla Oak	1200	3000
	Pearl Oak Pearl Oak		
	Iron Oak Iron Oak		
	Nature Oak Nature Oak		
	Harvest Oak Harvest Oak		
	Honey Oak Honey Oak		
	Arizona Oak Arizona Oak		
	Smoked Oak Smoked Oak		
	Graphite Oak Graphite Oak		
	Arábian Oak Arábian Oak		
	Castle Oak Castle Oak		
	Ivory Oak Oak Ivory		
	Barley Oak Barley Oak		
	Havana Oak Havana Oak		
	Coyote Oak Coyote Oak		
	Bohemian Walnut Bohemian Walnut		
Forest Oak Forest Oak			
Signature Oak Signature Oak			
Decor Branco White Decor Decor Blanc	1250	3000	

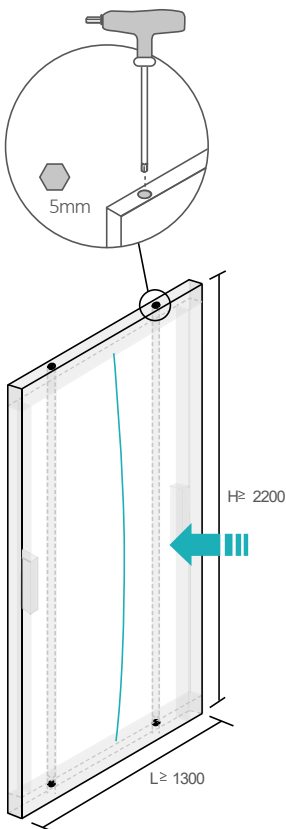

SISTEMA DE CORREÇÃO DE PORTA
Door straightener system
Système de redressement de porte

Tensor interno que permite corrigir a curvatura ou eventual empeno da porta, incluído em todas as portas GS DOORS com largura superior a 1200 ou altura superior a 2100 mm.

Door straightener that allows to correct a warped door, included in all GS DOORS with width greater than 1200 or height greater than 2100 mm.

Ferrure qui permet de redresser la courbure ou le gauchissement de la porte, inclus dans toutes les portes GS DOORS d'une largeur supérieure à 1200 mm et hauteur supérieure à 2100 mm.

GAMA GAMA GAMA	COR COLOR COULEUR	LM ↔	HM ↕
BASIC			
BASIC +			
STYLE	—	2000	3000
GLAM			
GRAPHIC			
VINTAGE	—	1250	3000
HPL	—	1230	3000

	COMPRIENTO Length Longueur	LARGURA Width Largeur	ESPESSURA Thickness Épaisseur
Porta Door Porte	+2mm	+2 mm	+1 mm
Aro Frame Husserie	-3;+5mm	-4; +2 mm	+1 mm
Guarnição Architrave Chambranle	-2;+10mm	+1 mm	+ 2mm